

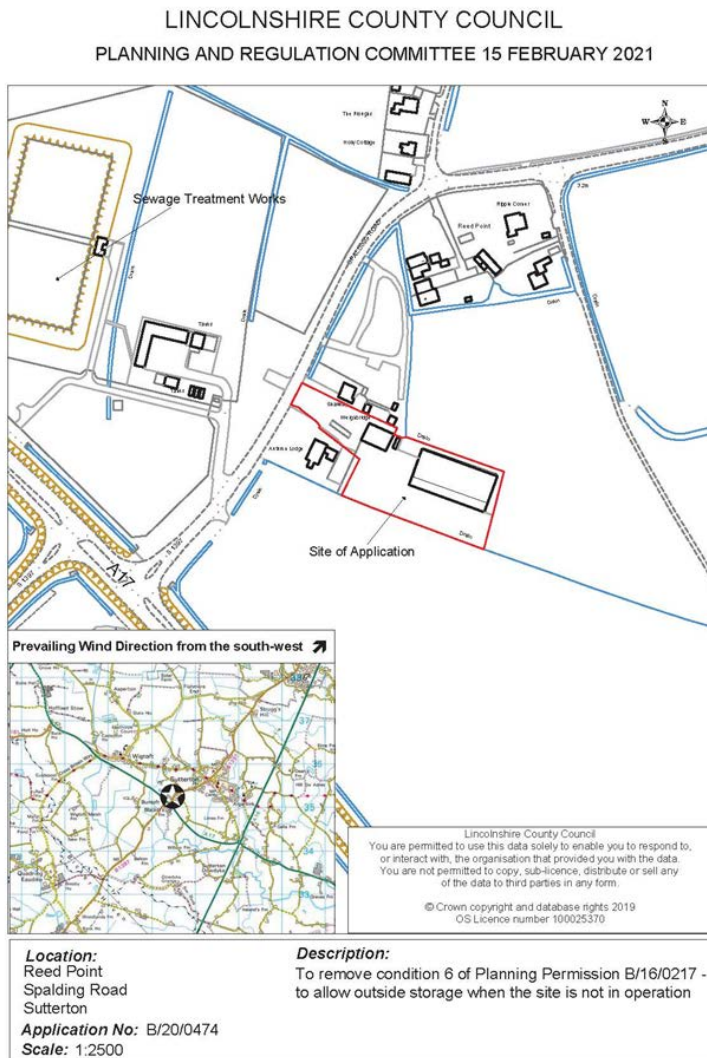

5.1 Sutterton

Agenda Item 5.1

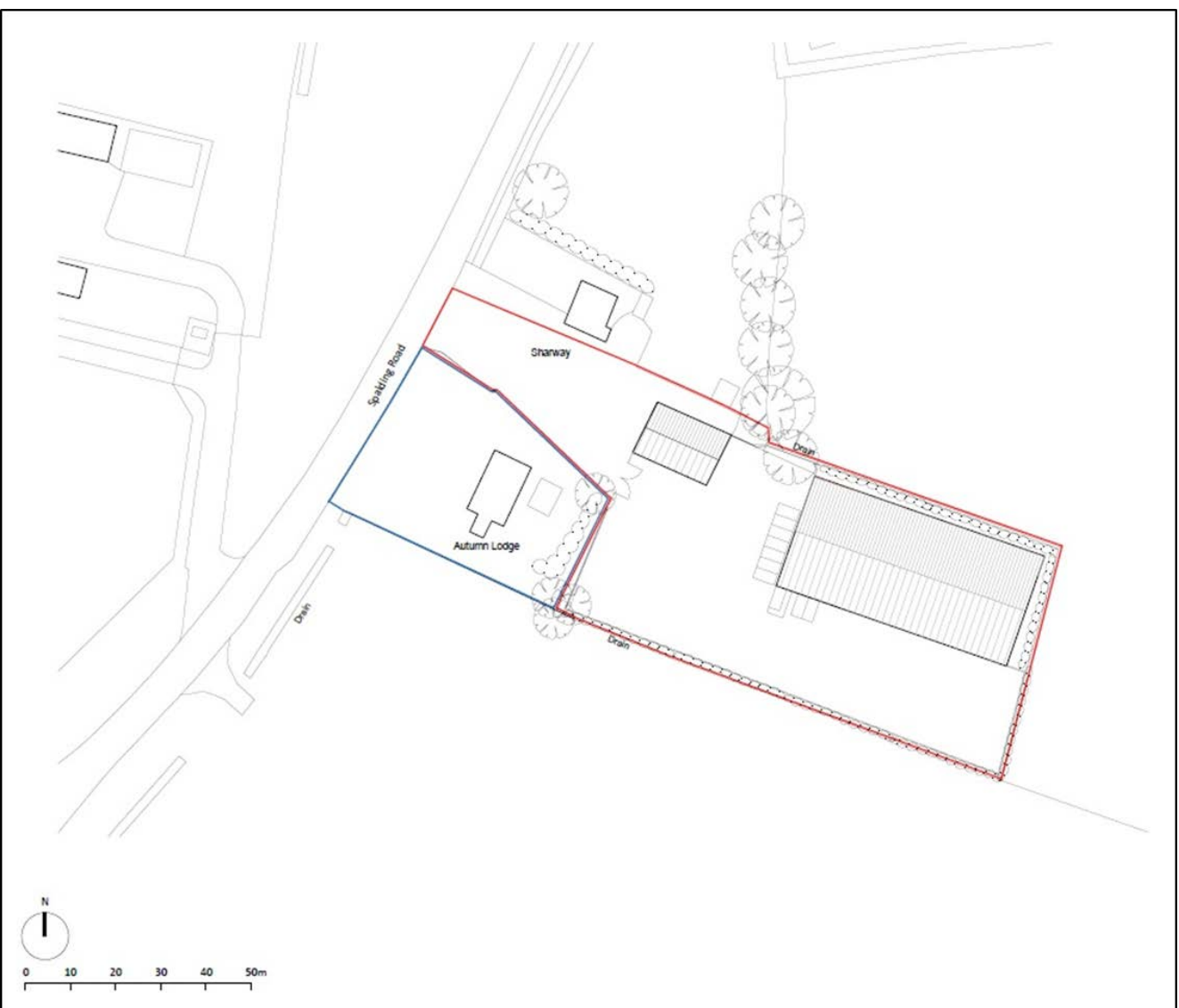





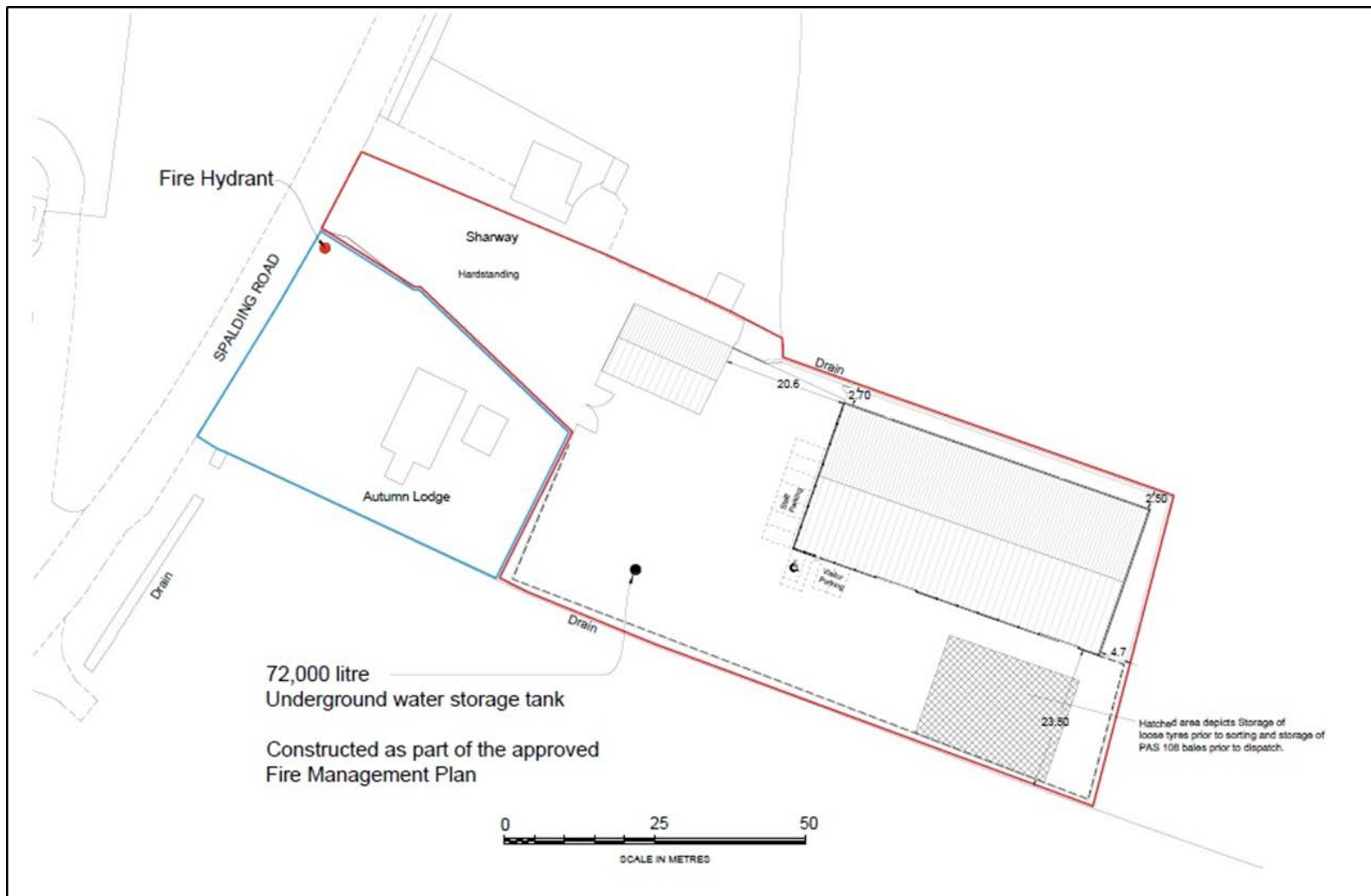



5.2 South Witham

LINCOLNSHIRE COUNTY COUNCIL
PLANNING AND REGULATION COMMITTEE 15 MARCH 2021

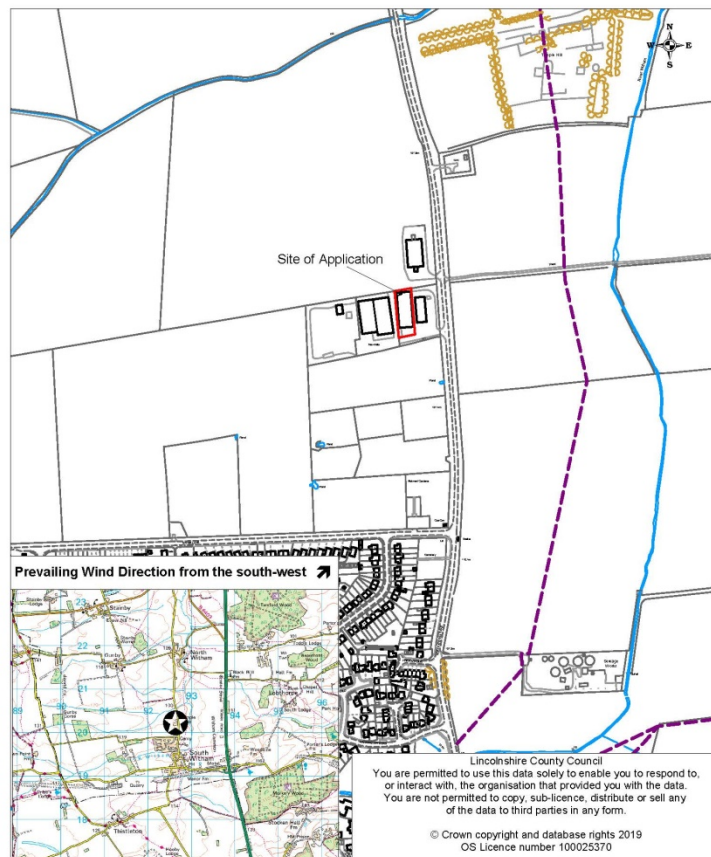

Location:
New Mills
North Witham Road
South Witham

Application No: S21/0153
Scale: 1:5000

Description:
For change of use of building from storage and distribution (Use Class B8) to waste plastics/polymer/PVC/rubber recycling facility (Sui Generis use)



